

# CLASSIC CLOSURES

## Quality Insulated Cavity Closures

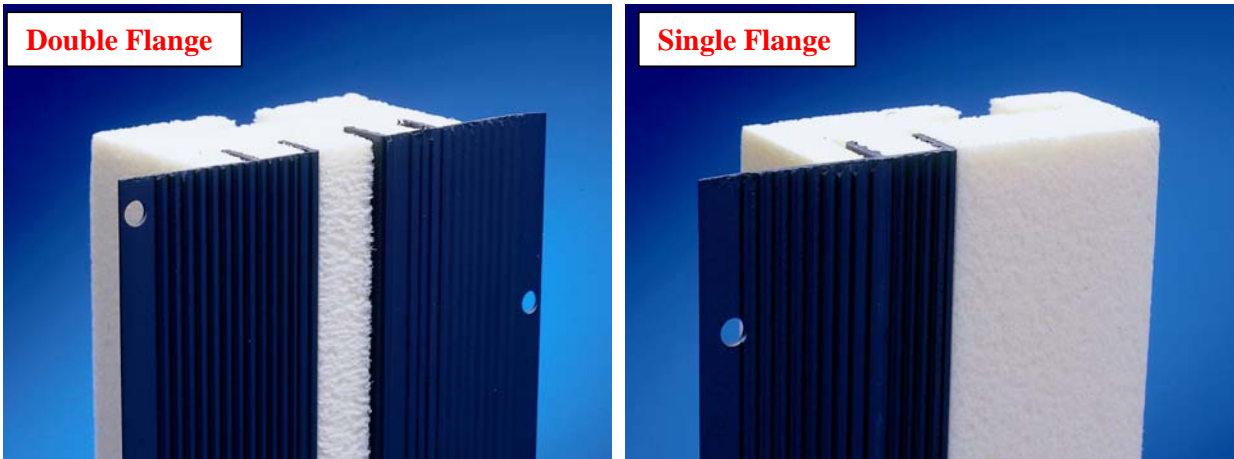

### *Key Features*

- ◆ *One Piece Solution*
- ◆ *Weather Resistant*
- ◆ *Lightweight*
- ◆ *Robust*
- ◆ *Minimal Waste*
- ◆ *Easily Installed*
- ◆ *Versatile*
- ◆ *Low cost*

**Classic Closures** are manufactured from closed cell extruded polystyrene insulation and UPVC extrusion. They provide a simple but effective one piece solution to closing the cavity in new masonry walls

Water resistant properties prevent any moisture tracking across the cavity without the use of a DPC. They are light to handle, yet robust, easily cut without the use of specialist tools or equipment. Waste is almost eliminated due to the unique way of joining two pieces together.

Window and door openings are formed and closed efficiently eliminating the time and costly process of cutting blocks or bricks

**Classic Closures** are suitable for use with Timber, metal, PVC windows and door frames for 1<sup>st</sup> fix, 2<sup>nd</sup> fix and check reveal applications. They are manufactured to suit cavity widths 50 –250 mm.

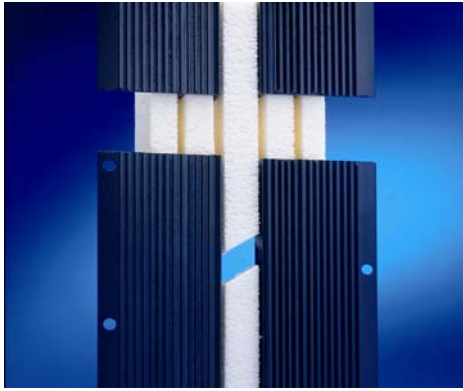

## Installation

**Classic Closures**, being so versatile, can be fixed to the window frame, installed during wall construction or retro-fitted after the wall construction is complete. *Window/door frames must overlap the cavity by a minimum of 15 mm and when using Classic Closure Single Flange ensure that the UPVC flange is located to the exterior wall.* Installation is simple, build the cavity wall to sill level and cut the closure to required length. The two closure jamb sections are cut to required length plus an additional 85 mm. This allows the jamb section to overlap the sill by 50 mm and is achieved by the insulation being cut away from the flange.



**Classic Closures** are easily cut using a fine tooth saw. Joining two pieces of closure is achieved with a minimal amount of waste. Slide the insulation through the UPVC flanges to create an overlap and cut the insulation at 45%. The two sections are then joined to form a rigid continuous piece.

To achieve secure fixing when constructing the wall around the closure, UPVC Wall Ties are located in the 'T' section at the rear of the closure and placed in the mortar joint at 600 mm centres. If fitting the closure retrospectively, use the appropriate fixing through the holes in the UPVC flange.

## Product Range

<i>Double Flange</i>		<i>Single Flange</i>
2.5 and 2.1	<b>Length/metres</b>	2.5 and 2.1
35	<b>Depth/mm</b>	30
50, 65, 75, 80, 90, 100	<b>Width/mm</b>	50, 65, 75, 80, 90, 100
20	<b>Pack quantity</b>	20
Approx. 600 lengths	<b>Palletised</b>	Approx. 600 lengths
Special Widths on request		
UPVC Wall Ties	:	Packet/100 : Boxes/1200
Check Reveal Closure	:	Available on Request
Insulated DPC	:	Available on Request



## Product Key Features

### Extruded Polystyrene Insulation

- ◆ HCFC/CFC free
- ◆ Thermal Insulation properties (0.31W/mK)
- ◆ Compressive Strength : 300 kPa
- ◆ 'T' Section Groove – Prevents water tracking & Wall Tie fixing

### Extruded UPVC Flange

- ◆ Very tough
- ◆ 25 mm flange overlap of brickwork
- ◆ 75 mm centre fixing holes
- ◆ Ribbed to accept plaster key

### Other References

- ◆ Installation Instructions
- ◆ Wall Tie Fixing Instructions

## Other Products

### Cavalok Cavity Closure & Frame Former



### VapR-free Breathable Membrane VapR-free Underlay Support Trays

