

# CLASSIC CLOSURES

## Quality Insulated Cavity Closures

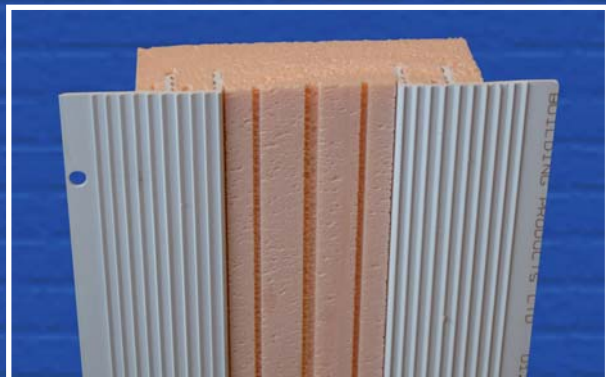

**Double Flange**



**Single Flange**

### Key Features

- CFC & HCFC free
- Zero ODP and GWP of 1
- Low Cost
- One Piece Solution
- Weather Resistant
- Lightweight
- Robust
- Minimal Waste
- Easily Installed

**Classic Closures** are manufactured from closed cell HCFC/CFC free extruded polystyrene insulation and recycled UPVC extrusion. Resulting in an Ozone Depletion rating of Zero and a Global Warming Potential of 1. **Classic Closures** provide a simple low cost, effective solution for closing cavities around window and door openings in new masonry walls.

Water resistant properties prevent any moisture tracking across the cavity without the use of a DPC. They are light to handle, robust and easily cut without the use of specialist tools or equipment. A unique feature is how two pieces can be easily joined together, eliminating waste and large grooves give improved adhesion for mortar.

**Classic Closures** are available in widths from 50mm to 300mm and are the ideal 1st and 2nd fix solution for use with timber, metal, PVC windows and door frames. They eliminate time and the costly process of cutting bricks and blocks to close the reveal.

### Quality Assurance

**Classic Closures** are manufactured to assessed ISO 9002 Quality Assurance procedures, complies with Building Regulations Approved Documents Part L1 and L2 and has **NHBC Approval**.

### Solving the Problem of Thermal Bridging

**Classic Closures** avoid thermal bridging occurring at window and door openings preventing heat loss and condensation by complying with the Accredited Construction Details. These recommend a minimum thermal resistance path through a proprietary cavity closer of  $0.45\text{m}^2\text{K/W}$  as calculated using the BRE method.

**Classic Closures with a minimum overlap of 30mm by the window frame over the cavity closer have a resistance value of  $0.67\text{m}^2\text{K/W}$**

**MERCURY**  
**BUILDING PRODUCTS**

Mercury Building Products Ltd  
114 Eckington Road  
Coal Aston  
Dronfield S18 3AY

Telephone: 01246.292816  
Fax: 01246.292867

e. mail : [danny@vaprfree.co.uk](mailto:danny@vaprfree.co.uk)  
[www.mercurybuildingproducts.com](http://www.mercurybuildingproducts.com)

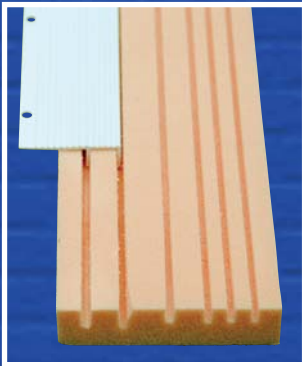

## Installation

When installing **Classic Closures**, the vertical jamb lengths should be cut to the required size and installed first. An additional 80mm should be allowed to ensure an overlap of the sill by 50mm. This is achieved by cutting away the UPVC flange or by sliding the flange through the foam and trimming at the top. The horizontal sill length is then cut to the required size and installed

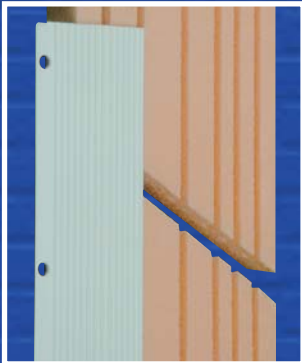

Window and door frames must overlap the cavity by a minimum of 30mm and the UPVC flange must always be located on the exterior wall. Secure fixing is achieved by mechanically fixing large headed nails through the holes provided in the UPVC flange.

**Classic Closures** are easily cut using a fine tooth saw and joining two pieces of closure is achieved with a minimal amount of waste. Slide the insulation through the UPVC flanges to create an overlap and cut the insulation at 45°. The two sections are then joined to form a rigid continuous piece.

## Product Details

Double and Single Flange	
2.5	Length/metres
30	Depth/mm
50, 65, 75, 80, 90, 100	Width/mm
12 No	Pack quantity
7-10	Pack Weight/kilo
110 – 300 mm	Special widths on request
Check Reveal Closure	Available on Request
Palletised	Available on Request



## Product Key Features

### Extruded UPVC Flange

- Recycled material
- 20 mm flange overlap of brickwork
- 150 mm centre fixing holes
- Ribbed to aid plaster key

### Extruded Polystyrene Insulation

- HCFC/CFC free
- Thermal Insulation Properties (0.34 W/mK)
- High Compressive Strength : 300 kPa
- Large grooves to aid plaster key
- Zero ozone depletion potential

## Other Products



### CAVALOK

Frame Formers  
Cavity Widths  
50 – 300 mm



### Multi-Cav

One piece solution for all  
Cavity Widths  
50 – 100 mm